

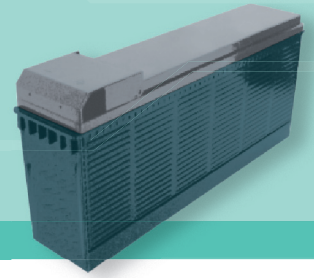

# ESL 95-12FT



## Application

- Telecom
- Communication Equipment
- Control Equipment
- Medical Equipment
- UPS
- Emergency Power System

## General Features

- Easy maintenance and installation
- No need for extra (wrench space) above battery
- Sealed and maintenance free operation
- Non-Spillable construction design
- ABS containers and covers(UL94HB, UL94V-0) optional
- Safety valve installation for explosion proof
- Maximized energy density for installation in relay rack trays
- High quality and high reliability
- Exceptional deep discharge recovery performance
- Flexibility design for multiple install positions

## Construction

- Component.....Raw material
- Sealant.....Epoxy Resin
- Positive .....Lead dioxide
- Safety valve .....EPDR
- Negative .....Lead

- Terminal .....Copper
- Cover .....ABS
- Electrolyte .....Sulfuric acid
- Separator .....Fiber glass
- Container .....ABS

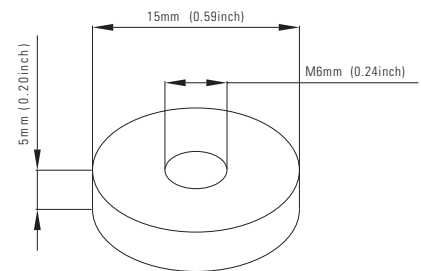

## Terminal Dimensions

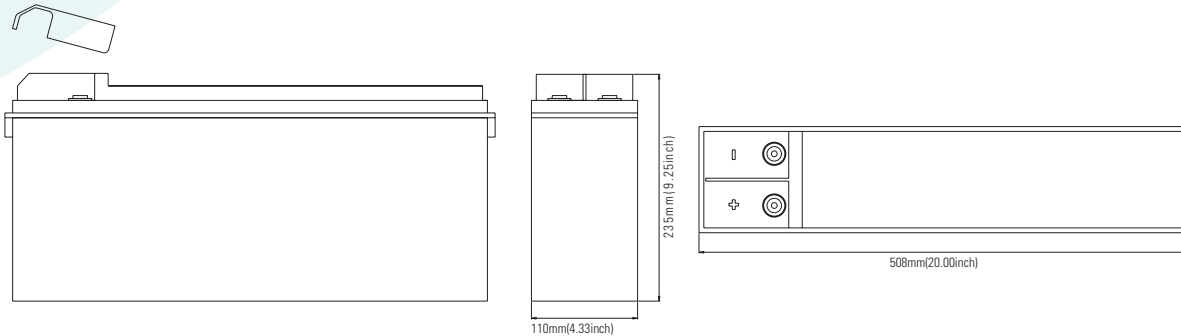

Battery Model	ESL 95-12FT			
Designed Floating Life	12 Years			
Capacity (25°C)	20HR(4.6A, 1.75V)	10HR(9A, 1.75V)	5HR(15.3A, 1.75V)	1HR(63A, 1.75V)
	92AH	90AH	76.5AH	63AH
Dimensions	Length	Width	Height	Total Height
	508mm(20.0inch)	110mm(4.33inch)	224mm(8.82inch)	239mm(9.41inch)
Approx. Weight	31.0Kg (68.4 lbs)			
Internal Resistance	Full charged at 25°C			
Self Discharge	3% of capacity declined per month at 25°C			
Capacity Affected by Temp. (20HR)	40°C	25°C	0°C	-15°C
	102%	100%	85%	65%
Charge Voltage (25°C)	Cycle use		Float use	
	14.4-15V(-30mV/ C), max. Current: 22.5A		13.6-13.8V(-20mV/ C)	

## Charge Characteristics

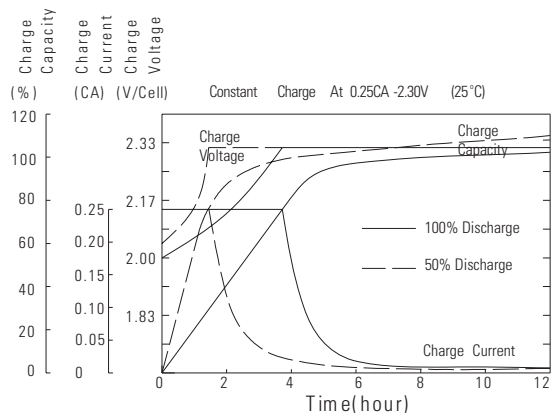

## Discharge Characteristics

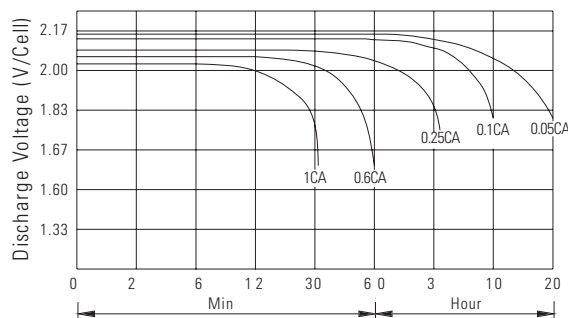

## Relationship of OCV and state of charge

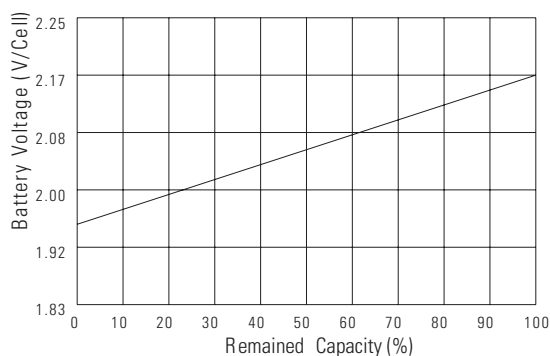

## Self Discharge Characteristics

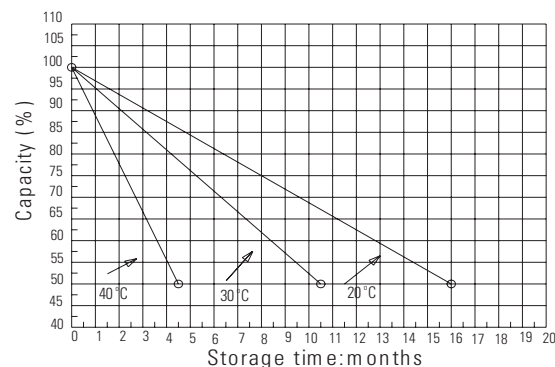

## Constant current discharge ratings-amperes at 25°C

FV/Time	5MIN	10MIN	15MIN	30MIN	1HR	3HR	5HR	10HR	20HR
1.60V	315	216	158	94.5	59.4	24.6	17.2	9.54	4.74
1.67V	284	197	153	91.8	59.3	24.5	17.0	9.40	4.73
1.70V	269	190	148	90.0	59.1	24.5	17.0	9.33	4.73
1.75V	239	176	140	88.2	58.5	24.3	16.9	9.17	4.70
1.80V	216	163	133	85.5	57.8	24.2	16.8	9.01	4.54
1.85V	164	134	115	78.7	57.2	24.1	16.6	8.85	4.47

## Constant power discharge ratings-watts at 25°C

FV/Time	5MIN	10MIN	15MIN	30MIN	1HR	3HR	5HR	10HR	20HR
1.60V	519	358	279	178	117	47.2	32.9	19.1	9.49
1.67V	492	354	276	175	113	47.2	32.9	18.8	9.45
1.70V	460	345	272	170	110	47.2	32.9	18.7	9.45
1.75V	428	322	256	166	109	46.4	32.5	18.3	9.41
1.80V	384	300	240	161	107	45.8	32.0	18.0	9.10
1.85V	308	248	210	148	106	45.6	31.5	17.7	8.90